

2010 ENGINE

Engine Mechanical - 4.8L, 5.3L, 6.0L, 6.2L, or 7.0L - Repair Instructions - On Vehicle - Camaro

DRIVE BELT REPLACEMENT - ACCESSORY

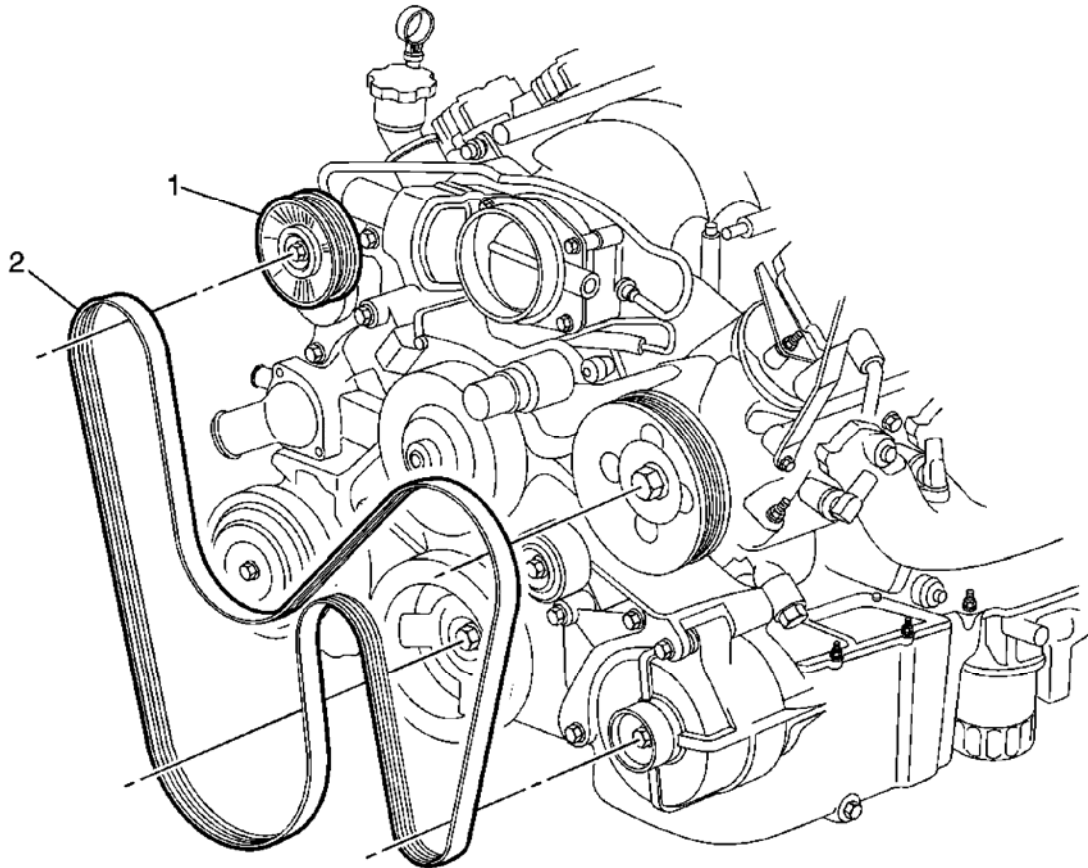

Fig. 1: Drive Belt - Accessory

Courtesy of GENERAL MOTORS CORP.

Callout	Component Name
1	<p>Drive Belt</p> <p>Procedure</p> <ol style="list-style-type: none"> 1. Use the proper tool to rotate the drive belt tensioner. 2. Remove the drive belt from the pulleys and tensioner.
2	<p>Drive Belt Tensioner</p> <p>Procedure</p>

2010 Chevrolet Camaro LT

2010 ENGINE Engine Mechanical - 4.8L, 5.3L, 6.0L, 6.2L, or 7.0L - Repair Instructions - On Vehicle - Camaro

1. Clean and inspect the drive belt surfaces of all the pulleys.
2. Inspect the drive belt for correct alignment.

AIR CONDITIONING COMPRESSOR BELT REPLACEMENT

REMOVAL PROCEDURE

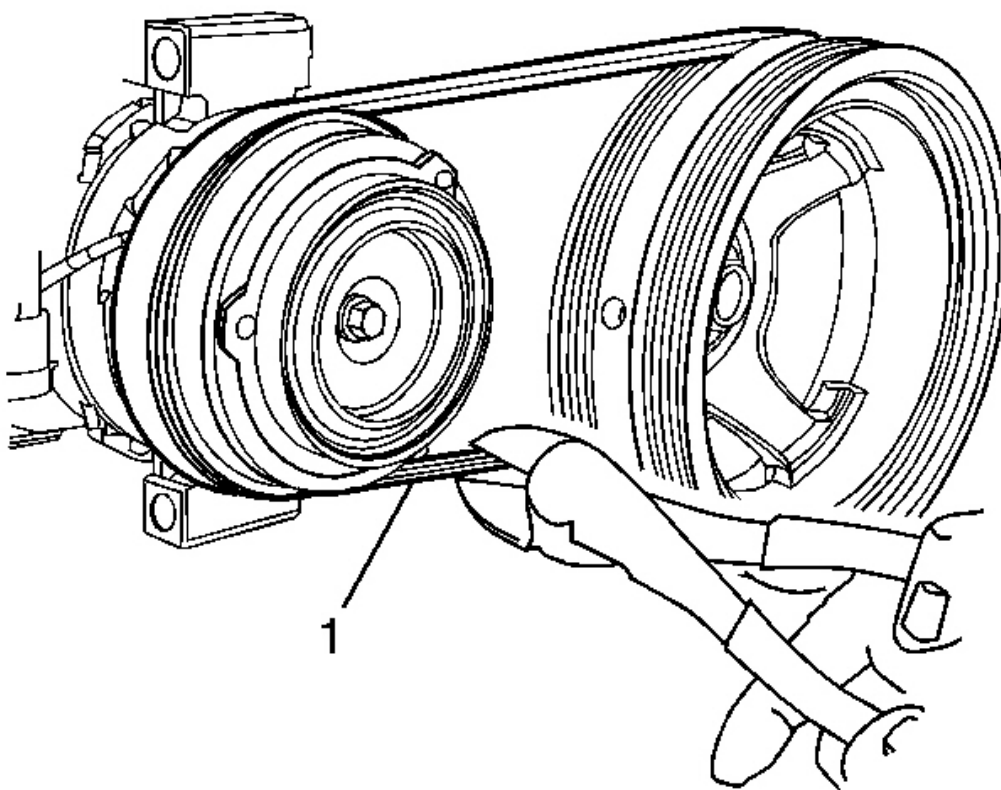

Fig. 2: Cutting Belt

Courtesy of GENERAL MOTORS CORP.

1. Remove the accessory drive belt. Refer to **Drive Belt Replacement - Accessory**.
2. Cut the belt (1) from air conditioning (A/C) and crankshaft pulleys.

INSTALLATION PROCEDURE

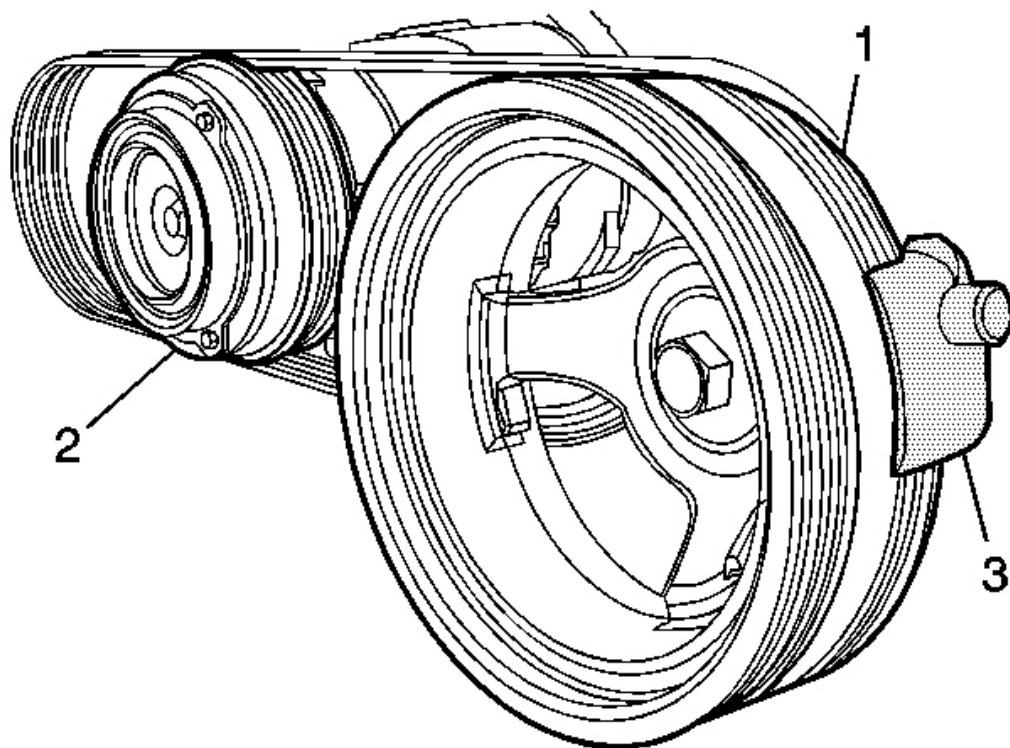

Fig. 3: Belt Installation Tool

Courtesy of GENERAL MOTORS CORP.

1. Position the belt behind the rear face of the balancer (1) and off of the A/C pulley (2).
2. Install the belt installation tool (3) onto the balancer.

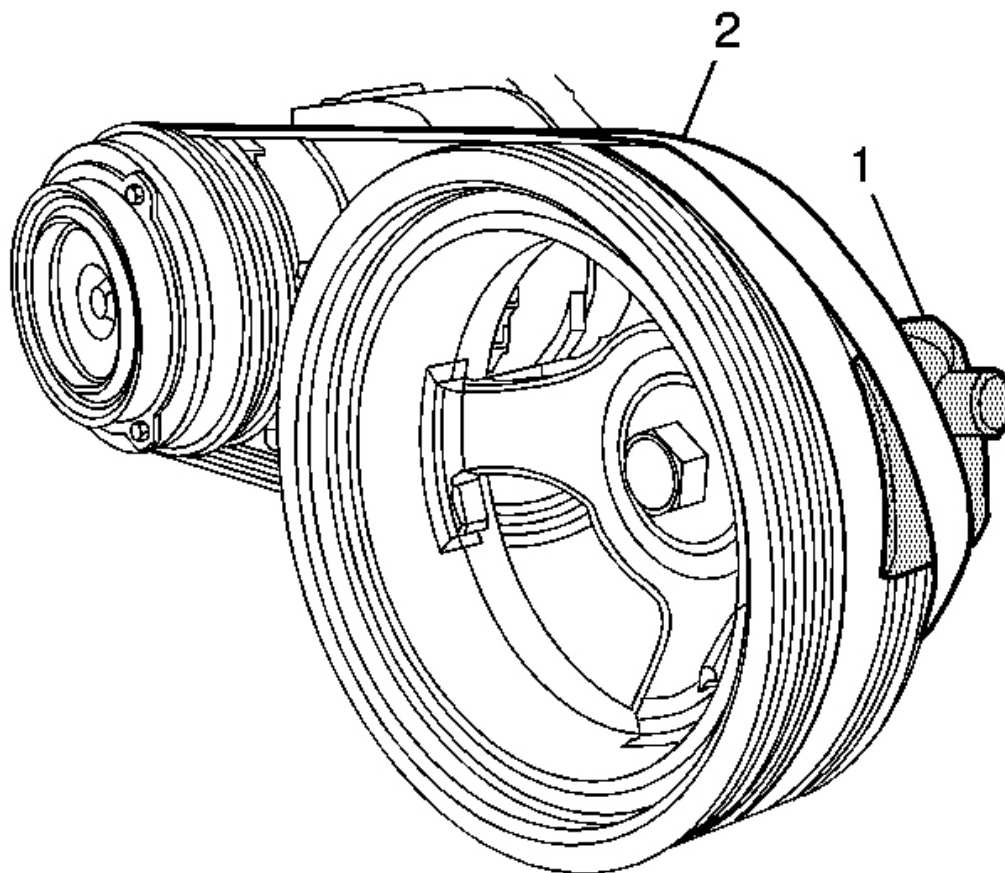

Fig. 4: InstallingBelt

Courtesy of GENERAL MOTORS CORP.

NOTE: For RPO L99 applications, it may be necessary to loosen and reposition or remove the camshaft position sensor/actuator wire harness bracket for belt installation.

3. Slide the belt installation tool (1) upward, installing the belt (2) onto the belt installation tool.

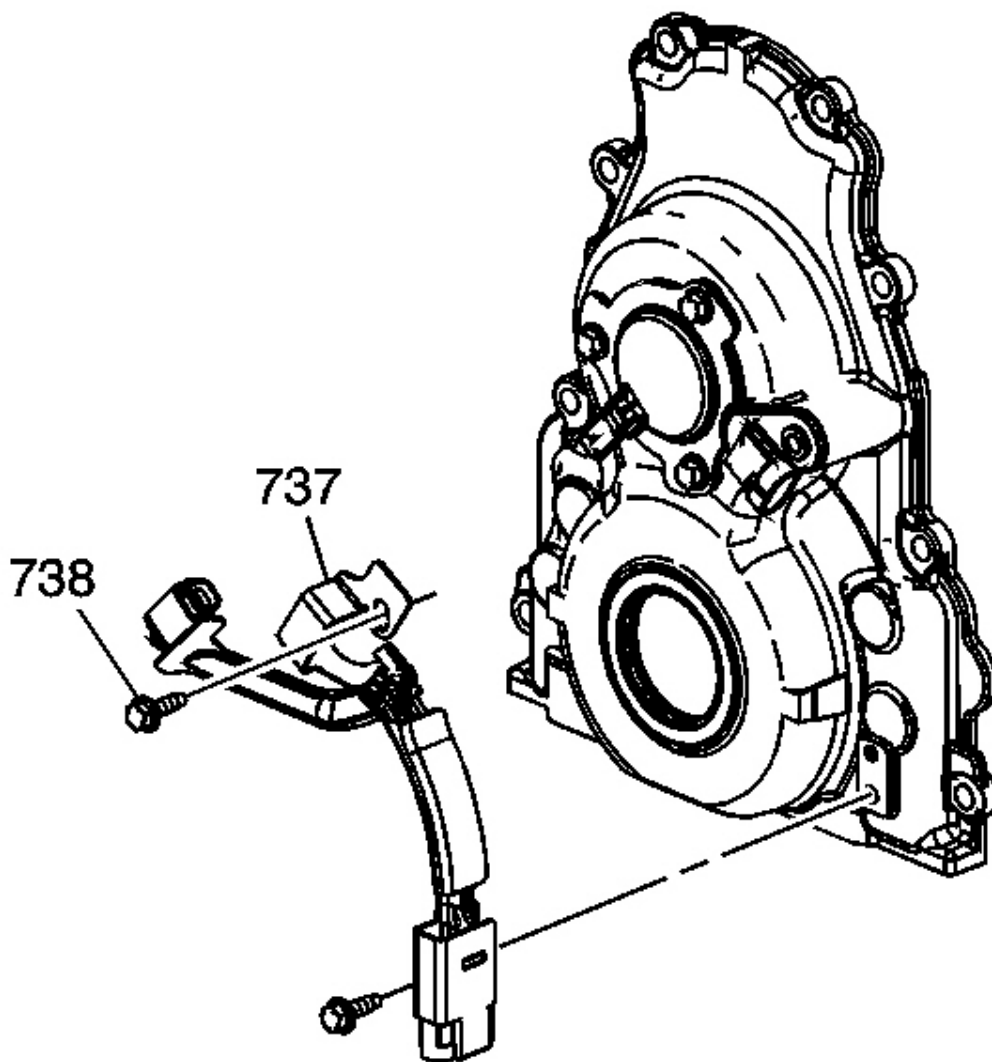

Fig. 5: View Of CMP Sensor Wire Harness & Bolts
Courtesy of GENERAL MOTORS CORP.

4. Loosen the camshaft position sensor/actuator wire harness bracket bolts (738) and reposition or remove the bracket (737) as required.
5. Slide the belt installation tool downward, positioning the belt onto the A/C pulley, applying light tension to the belt.

2010 Chevrolet Camaro LT

2010 ENGINE Engine Mechanical - 4.8L, 5.3L, 6.0L, 6.2L, or 7.0L - Repair Instructions - On Vehicle - Camaro

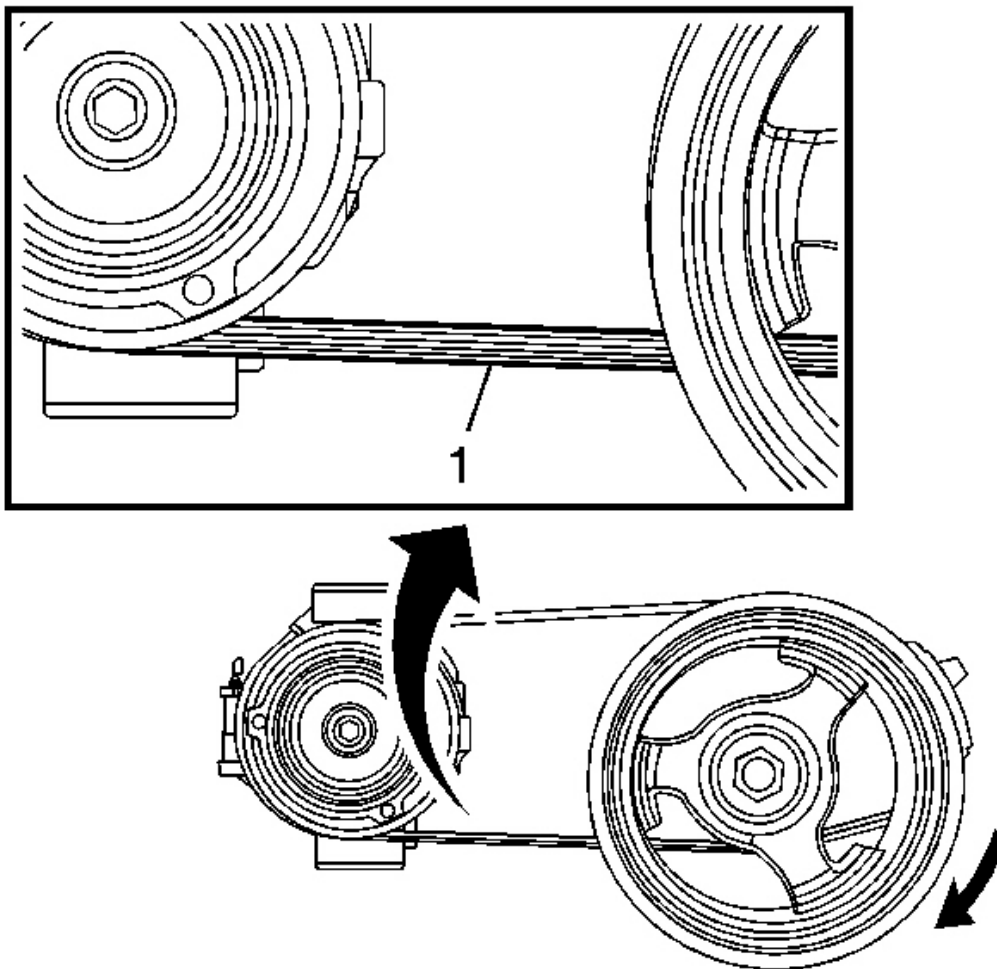

Fig. 6: Positioning Lower Portion Of Belt
Courtesy of GENERAL MOTORS CORP.

6. Position the lower portion of the belt (1) with the ribbed area facing forward.

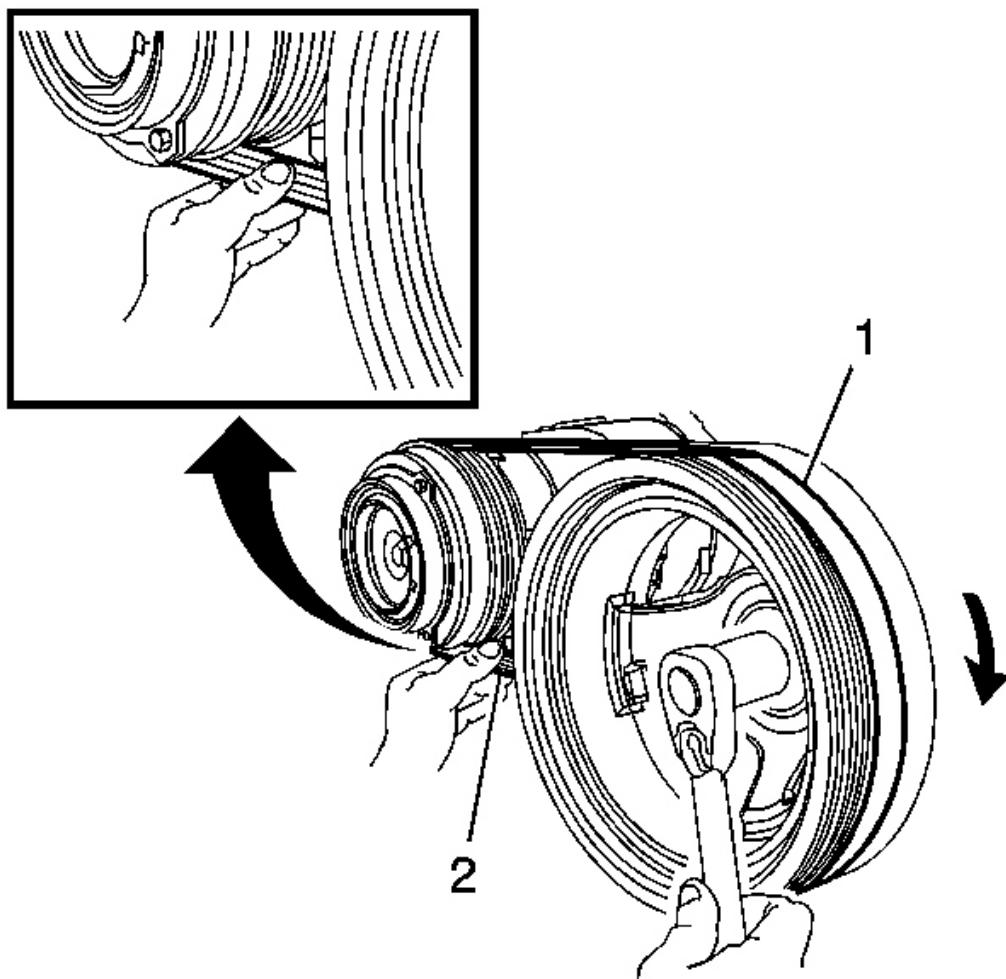

Fig. 7: Rotating Crankshaft Pulley
Courtesy of GENERAL MOTORS CORP.

7. Slowly rotate the crankshaft pulley (1) in a clockwise direction while using finger pressure to pull the belt (2) forward. Ensure that the ribbed area of the belt remains facing forward and the belt aligns properly to the A/C pulley.

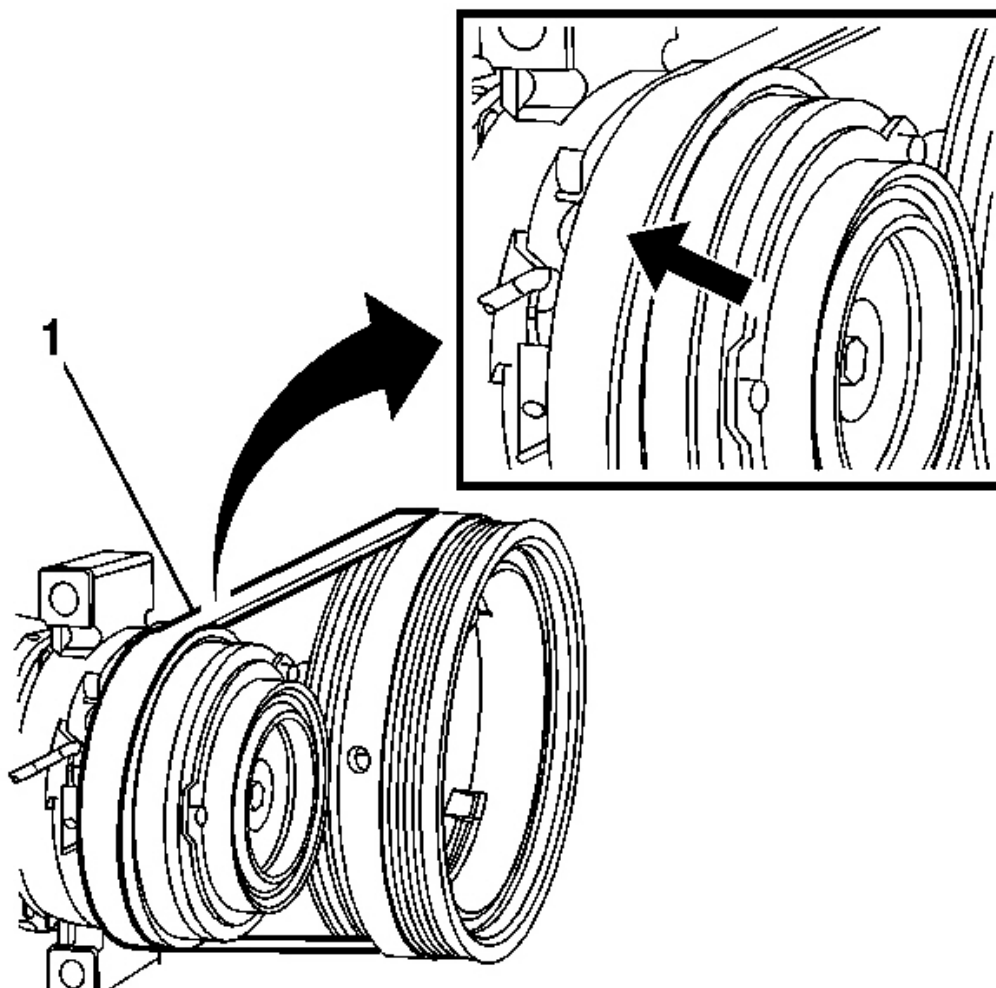

Fig. 8: Drive Belt Alignment

Courtesy of GENERAL MOTORS CORP.

8. Inspect the drive belt (1) for proper installation and alignment.

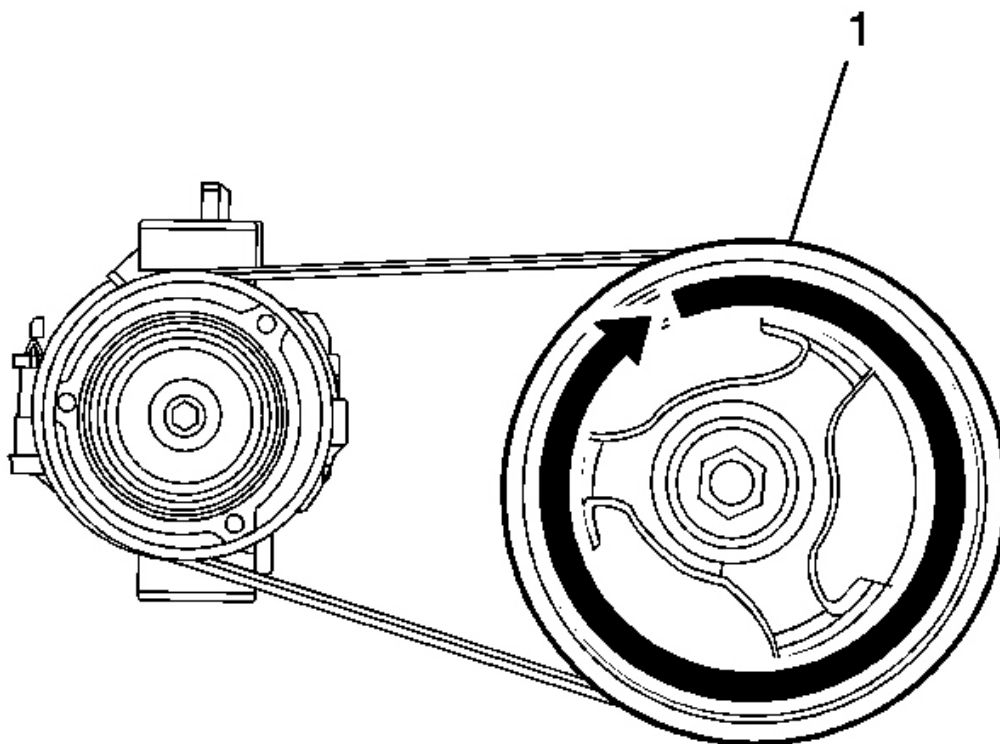

Fig. 9: Rotating Balancer

Courtesy of GENERAL MOTORS CORP.

9. Rotate the balancer (1) and additional 360 degrees to ensure proper belt installation.

CAUTION: Refer to **Fastener Caution** .

10. Reposition the camshaft position sensor/actuator wire harness bracket and tighten the bolts as required.

Tighten the bolts to 12 N.m (106 lb in).

11. Install the accessory drive belt. Refer to **Drive Belt Replacement - Accessory**.

DRIVE BELT IDLER PULLEY REPLACEMENT

2010 Chevrolet Camaro LT

2010 ENGINE Engine Mechanical - 4.8L, 5.3L, 6.0L, 6.2L, or 7.0L - Repair Instructions - On Vehicle - Camaro

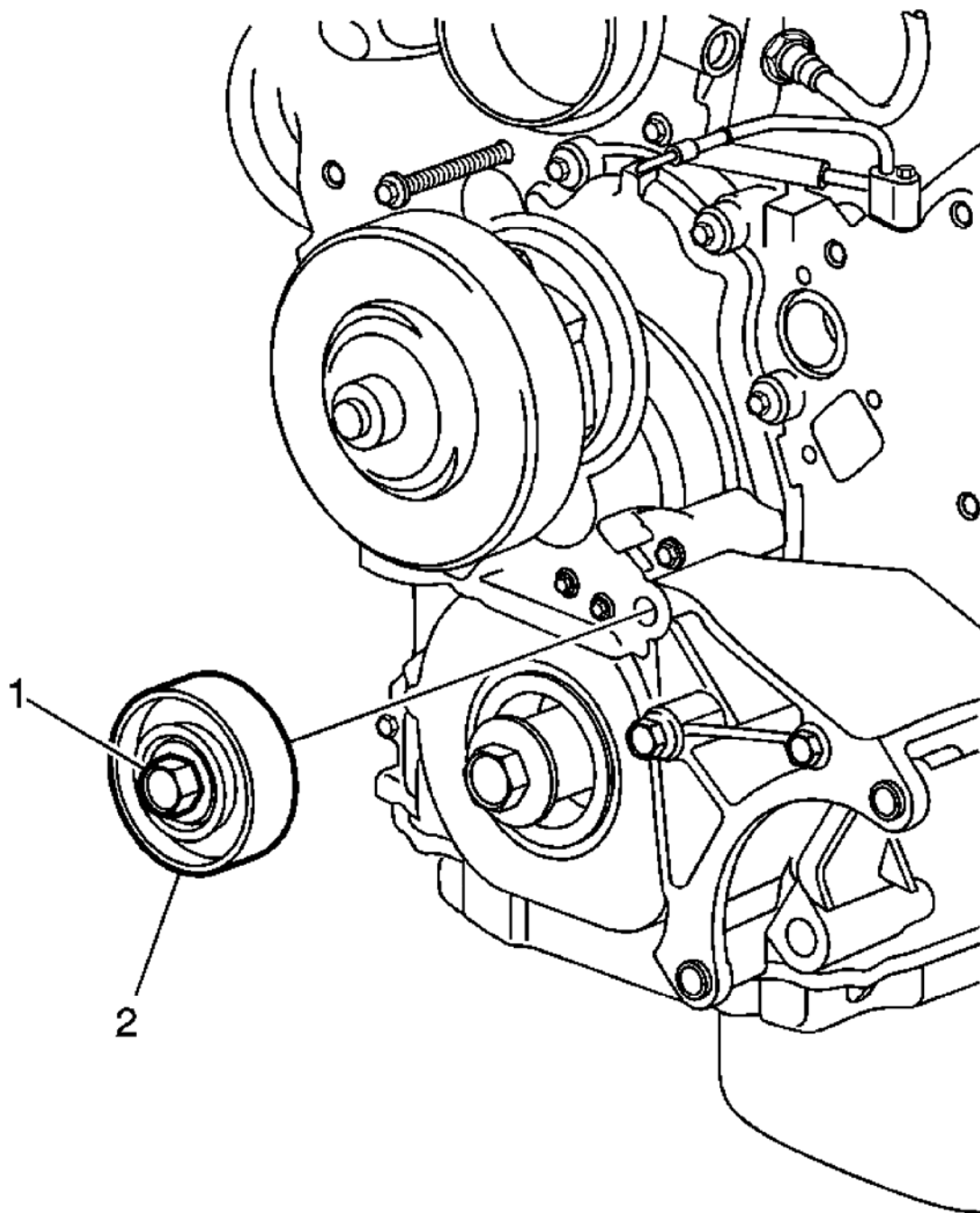

Fig. 10: Drive Belt Idler Pulley

Courtesy of GENERAL MOTORS CORP.

Callout	Component Name
Preliminary Procedure: Remove the drive belt. Refer to <u>Drive Belt Replacement - Accessory.</u>	
	Drive Belt Idler Pulley Fastener

2010 Chevrolet Camaro LT

2010 ENGINE Engine Mechanical - 4.8L, 5.3L, 6.0L, 6.2L, or 7.0L - Repair Instructions - On Vehicle - Camaro

1	CAUTION: Refer to <u>Component Fastener Tightening Caution</u> . Tighten: 50 N.m (59 lb ft)
2	Drive Belt Idler Pulley Procedure: Transfer components as necessary.

DRIVE BELT TENSIONER REPLACEMENT - ACCESSORY

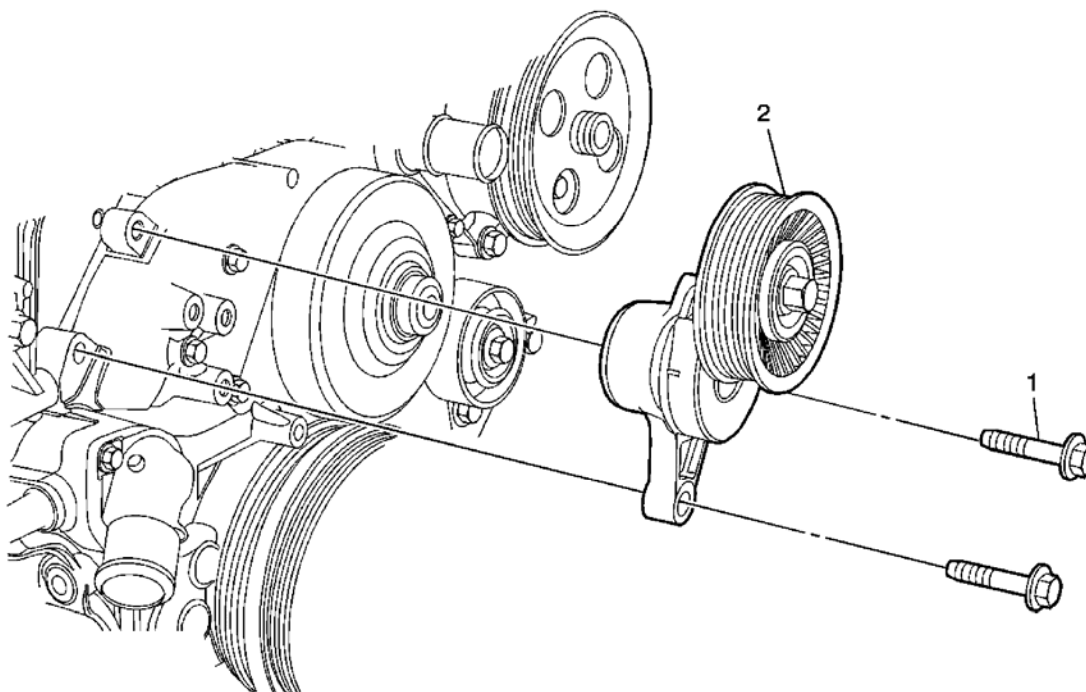

Fig. 11: Drive Belt Tensioner - Accessory
Courtesy of GENERAL MOTORS CORP.

Callout	Component Name
Preliminary Procedure: Remove the drive belt. Refer to <u>Drive Belt Replacement - Accessory</u> .	
1	Drive Belt Tensioner Fastener (Qty: 2) CAUTION: Refer to <u>Component Fastener Tightening Caution</u> . Tighten: 50 N.m (59 lb ft)
	Drive Belt Tensioner